

MOEN® 摩恩

淋浴杆 安装说明书

Shower Bar INSTALLATION INSTRUCTIONS

如需安装支持，配件丢失等，请联系MOEN。
(中国) 400-630-8866
www.moen.cn

PLEASE CONTACT MOEN FIRST
For Installation Help, Missing or Replacement
Parts
(China) 400-630-8866
www.moen.cn

推荐工具

为了安全和让安装和替换变得容易，Moen建议您使用以下工具：

HELPFUL TOOLS

For safety and ease of replacement, Moen recommends the use of these helpful tools.

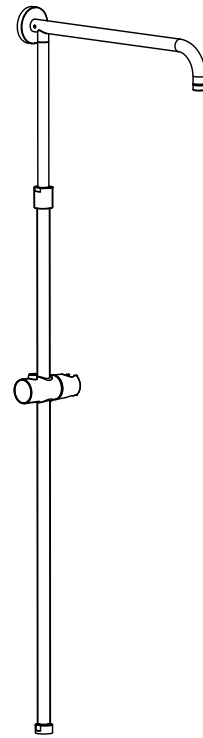
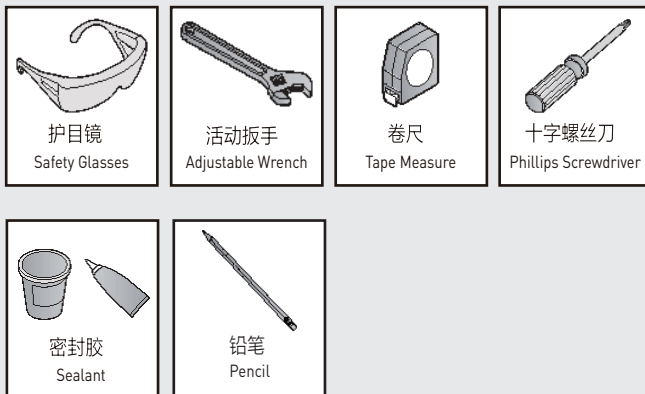

图片仅供参考
(款式因型号而异)

Image is for reference only
(Style varies by model)

记录购买的型号：
(保存安装说明书以备将来参考)

Record Purchased Model Number:
(Save instruction sheet for future reference)

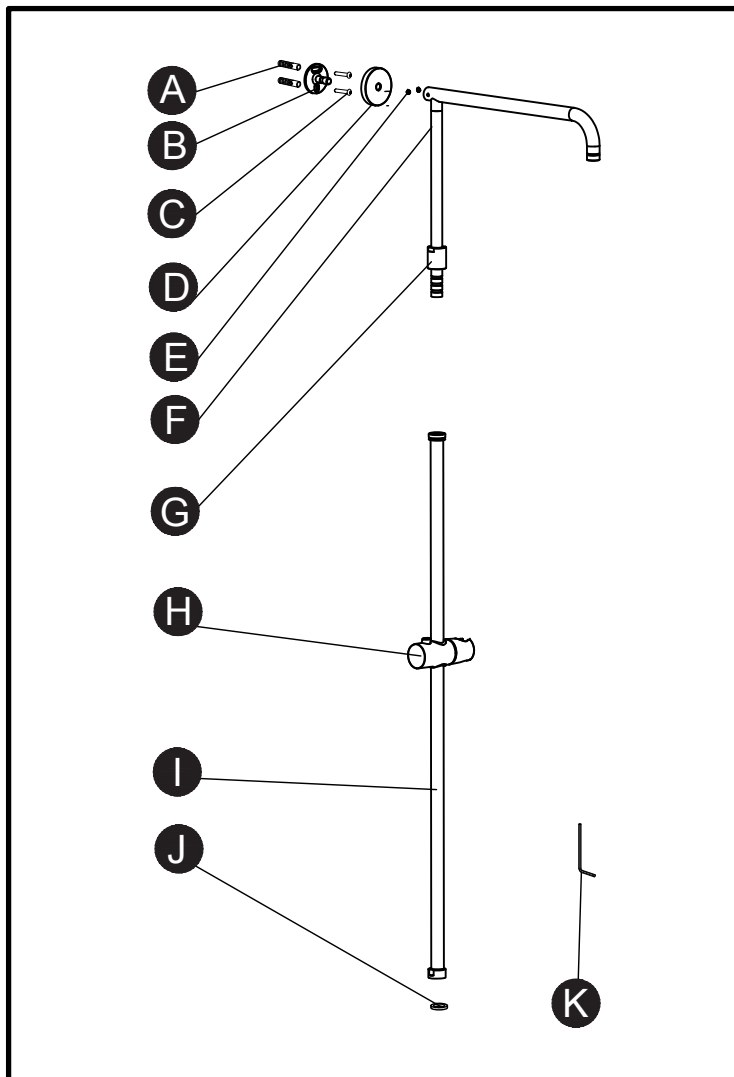

零件清单

- A. 膨胀管 (2x)
- B. 固定墙座
- C. 自攻螺丝 (2x)
- D. 装饰罩
- E. M6顶丝 (2x)
- F. 弯管
- G. 压紧螺母
- H. 滑座
- I. 直管
- J. 橡胶垫片
- K. 内六角扳手

Parts List

- A. Wall Plug (2)
- B. Fixing Ring
- C. Tapping Screw (2)
- D. Cover
- E. M6 Screw (2)
- F. Upper bend
- G. Nut
- H. Slide Bracket
- I. Straight Tube
- J. Washer
- K. Hexagon Wrench

★清点零件时注意: M6顶丝(E)安装在其安装孔中;压紧螺母(G) 装配在弯管(F).上;滑座 (H) 装配在直管(I). 上。安装前需将其取出后再按照后面的说明步骤操作。

Please kindly noted when checking the spare parts: the M6 jack screw (E) is installed in its installation hole; the compression nut (G) is installed on the elbow pipe (F); the shower holder (H) is installed on the straight pipe (I). Before installation, take it out and then follow the following steps.



移除旧龙头注意事项:

拆除现有水龙头或拆卸阀门之前, 请务必先关闭供水。打开水龙头手柄以释放水压, 确保完全关闭水源。

CAUTION — TIPS FOR REMOVAL OF OLD FAUCET:

Always turn water supply OFF before removing existing faucet or disassembling the valve. Open faucet handle to relieve water pressure and ensure that complete water shut-off has been accomplished.

申明:本公司保留更改产品结构不另行通知的权利。

1.本产品已经通过出厂检测及调试，请勿自行拆卸。

2.安装前,请务必先清除墙体预埋水管内的杂物及污泥,以免影响出水功能。

3.本产品的工作压力: 0.05MPa~0.6MPa,推荐工作压力0.2MPa~0.5MPa.

4.当您在钻孔和安装时请注意安全。

DECLARE:We reserve the rights to alter the structure of the product without any notice.

1.The product has been passed the functionality test before ex-factory,please do not disassemble by yourself at will.

2.The working pressure of this product is 0.05MPa~0.6MPa.The recommended water pressure is 0.2MPa~0.5MPa.

3. Please be careful of your security while downloading and installing.

1

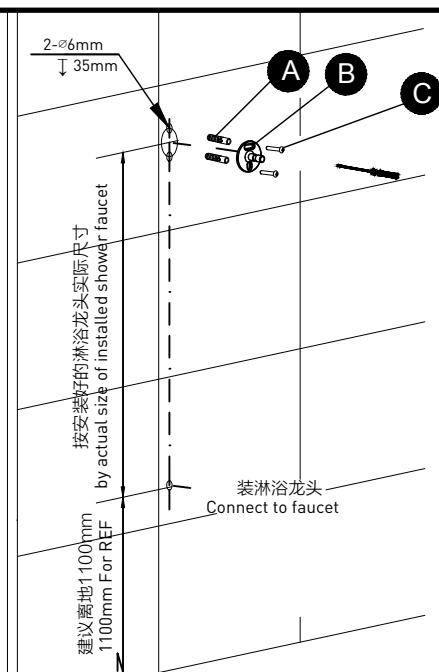

1. 用6 mm的钻头在墙上钻两个深度35mm的孔;
2. 在上述孔内打入膨胀管(A), 用自攻螺钉(B)将固定墙座(C)锁紧在墙面上。

1. Drill two 06mm/depth 35mm holes ;
2. Insert the wall plugs(A), fasten the fixing rings(B) on the wall.

3

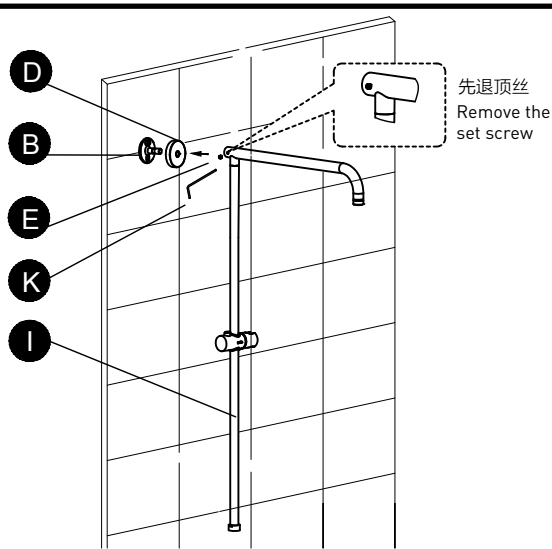

安装杆式淋浴器
将装饰罩(D)套在固定墙座(B)上, 然后将组装的杆式淋浴器套入固定墙座, 紧贴墙面, 锁紧顶丝。
★拿起装配好的杆式淋浴器时, 需要抓住淋浴龙头防止淋浴龙头掉下砸伤

- Install the fixing ring:
1. Drill two 06mm/depth 35mm holes.
 2. Insert the wall plugs(A), fasten the fixing rings(B) on the wall.
- When picking up the assembled shower bar, you need to hold the faucet to avoid falling and cause injury.

2

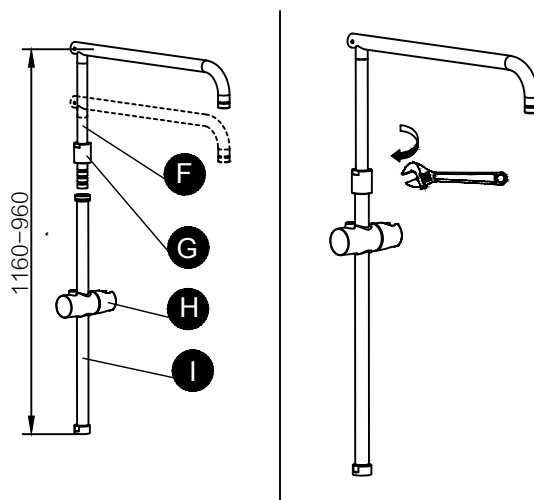

1. 弯管(F)插入直管(I)调节高度200MM
2. 用扳手锁紧螺母。

1. Shower arm adjustable range 0-200mm
2. Lock the nut with a wrench

4

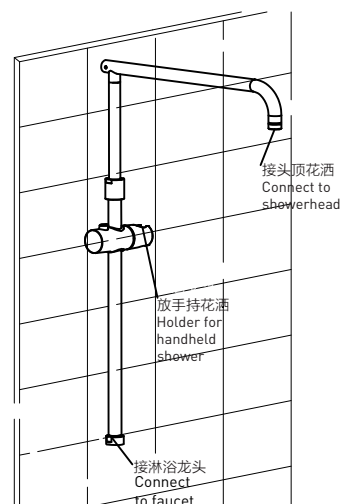

淋浴龙头、花洒软管、手持花洒及头顶花洒需要另购。
安装后请检查各连接处是否连接紧密、管道是否有泄漏, 整体安装是否牢固。确定各部位良好后, 可放水试用, 检查连接处是否漏水。

Not including faucet, shower hose, handheld shower and showerhead.
Check up every step to ensure the stability and tightness to avoid any leaking before testling the shower spray

产品售后保修条款

摩恩产品是在高质量标准及生产工艺下制造的，摩恩承诺为消费者购买的洁具产品提供有期限免费保修及终身维修服务。

淋浴杆免费保修期为1年有限。均自消费者购买日（以摩恩产品分销商开具的发票或收据上载明日期为准）起计。

免费保修范围为产品及产品配件由于材质及工艺原因而造成的故障或损坏。免费保修期内，我们将无偿为您提供修理服务及更换发生故障的产品或产品配件。摩恩的售后服务责任仅限于对故障产品的修理，而不延及您因产品故障而发生的其他损失，法律另有规定的除外。

您需了解：产品外观碰伤、刻划痕迹，以及滥用及不正当保养所导致的故障或损坏，均不属于免费保修范围。即使在免费保修期内，属下列（1）-（5）情况之一的，需酌情收取修理费用：

1. 不能出示相符的保修卡和有效购买凭证情况的，
2. 未按使用说明书告知的使用方法和注意事项造成的故障，
3. 自行拆卸、维修、改装所造成的故障和损坏，
4. 由于不可抗力等外部原因引起的故障和损坏，
5. 由于运输、搬运、挤压等造成的损坏。

对于保修期外或不在保修范围内的产品，如需维修，摩恩将酌情收取上门费、人工费及材料费。本保修条款仅对原始消费者和酒店行业的购买者有效，并不适用于本产品工业、商业、贸易和非酒店行业的使用。

如对本保修条款内容有任何疑问，请拨打400 630 8866咨询热线，或向当地分销商咨询。

MOEN® 摩恩

合格证 Compliance Certification

产品名称 淋浴杆
Product Name Shower Bar

检验员
Inspector

生产日期
Date of Production

富俊汇赢科技（上海）有限公司
中国（上海）自由贸易试验区新杨公路
1800弄1号4幢207室
邮编:201413

Fortune Brands Innovations (Shanghai) Co., Ltd
Room 207, Building 4, No. 1, Lane 1800, Xinyang Highway,
China (Shanghai) Pilot Free Trade Zone

MOEN LIMITED WARRANTY

We offer limited warranty and lifetime maintenance for Moen products, which are all manufactured with high standards of workmanship.

The period of warranty shall start from the date of purchase of the product (according to the invoice or receipt issued by Moen distributors) and shall cover a period of the following: the warranty period for shower bar is 1 year.

This warranty is your coverage against material and workmanship malfunction or defects in Moen products or components. During the warranty period, we offer free maintenance and changing of malfunctioned products or product components. Moen's after sales service liability is limited to the maintenance of faulty items and does not cover your other losses caused by product malfunction, except for other wise stipulated by law.

Cosmetic damages (scratches, dents, etc.) and malfunction or defects caused by abuse or improper maintenance is not covered by this warranty. Although the warranty period remains valid, in case of the following conditions (1)- (5), the maintenance cost [material cost and labor cost] shall still be charged as the case may be:

1. Corresponding warranty card and valid invoice cannot be presented;
2. Faults were caused by the incompliance with the instructions and precautions provided in the user's manual;
3. Damages and faults were caused by self-actuated dismantling, repair and refit;
4. Faults and damages were caused by external factors such as force majeure;
5. Damage were caused by transportation, unloading and extrusion, etc.

This warranty is valid for the original consumers only (including hotel use), and excludes industrial and commercial use of the product [except for hotel use]. This card is only responsible for product maintenance rather than any other liabilities.

In the event that the product requires maintenance but exceeds the warranty period, or that the product is not covered by this warranty, labor cost and material cost shall be charged as the case may be.

Please call 400-630-8866 or contact local dealer for any question.