

SPECIFICATIONS

规格书

臀洗、妇洗、水温调节、座温调节、座圈加热、抗菌座圈、座圈感应、来电自启、安全保护、休眠模式、抗菌喷枪、空气隔离和防止逆流等。

Rear Wash, Front Wash, Water Pressure Adjustment, Water Temperature Adjustment, Seat Heating, Antimicrobial Seat, Sitting Sensor, Auto-start, Safety Protection, Automatic Power Off, Antimicrobial Nozzle, Air Isolation, Anti-counterflow, etc.

产品尺寸 Product Dimensions: 520 x 380 x 112mm

水效等级 Water Efficiency: 3级 Grade 3

供水压力范围 Inlet Water Pressure Range:

0.08MPa-0.75MPa

输入 Input: 220VAC, 50Hz

额定功率 Rated Power: 1535W

电击防护类别 Electric Shock Protection Category: TYPE I

防水等级 Waterproof Level: IPX4

安全装置 Security Device:

双金属片温控器、温度保险 Bimetal Thermostat, Thermal Cutoff

执行标准 Execute Standard:

(凡不注明日期, 即为最新版本 Unless otherwise dated, it is considered to be the latest version)

GB/T 34549

GB 38448

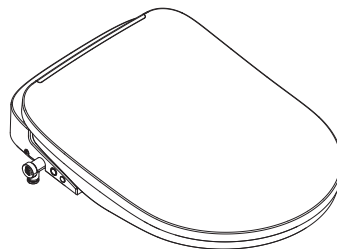

欧瑞莱系列

智能盖板

AURELIA Series

e-Bidet

MODELS: SW2071

注意：本公司保留随时变更图中标示尺寸的权力，无需另行通知

Note: The company reserves the right to change the dimensions on the drawing without prior notice.

产品尺寸 Product Dimensions

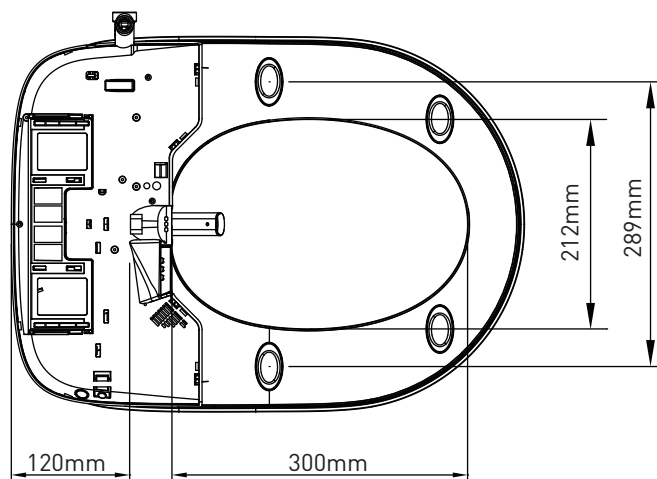
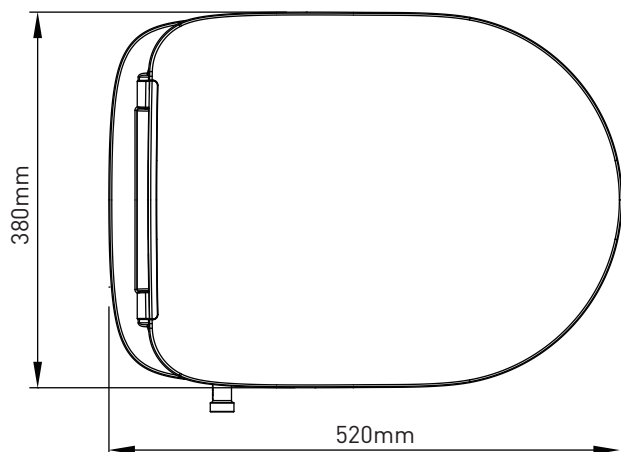
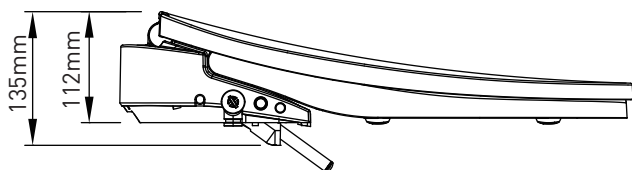

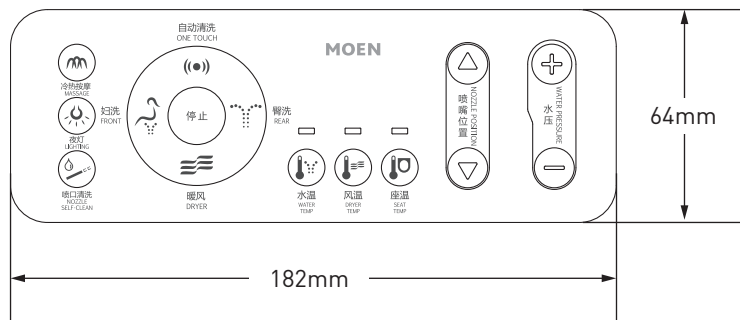

安装尺寸 Installation Dimensions

选择时参考依据：(下图示尺寸仅作为选择盖板的参考，请以实物为准)

Reference basis for selection: (The size shown below is only used as a reference for selecting the cover plate, please refer to the actual)

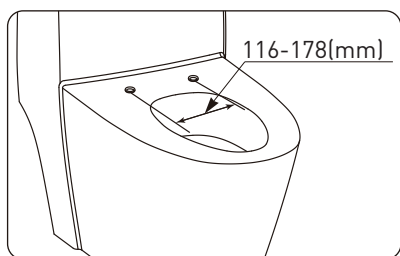

安装孔距离116-178mm之间
The distance between mounting holes is 116-178mm

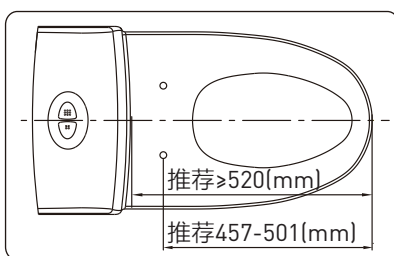

安装孔距前端457-501mm之间
水箱距离前端≥520mm
The distance between the mounting holes and the front end is 457-501mm
Tank distance front ≥520mm

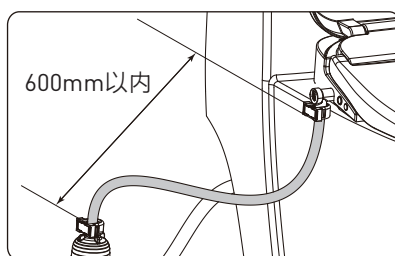

左侧距离角阀600mm以内
The left side is within 600mm of the Angle valve